

MotorGuide REPAIR PARTS

Model: POWER *plus*
BT67V
BACKROLLER

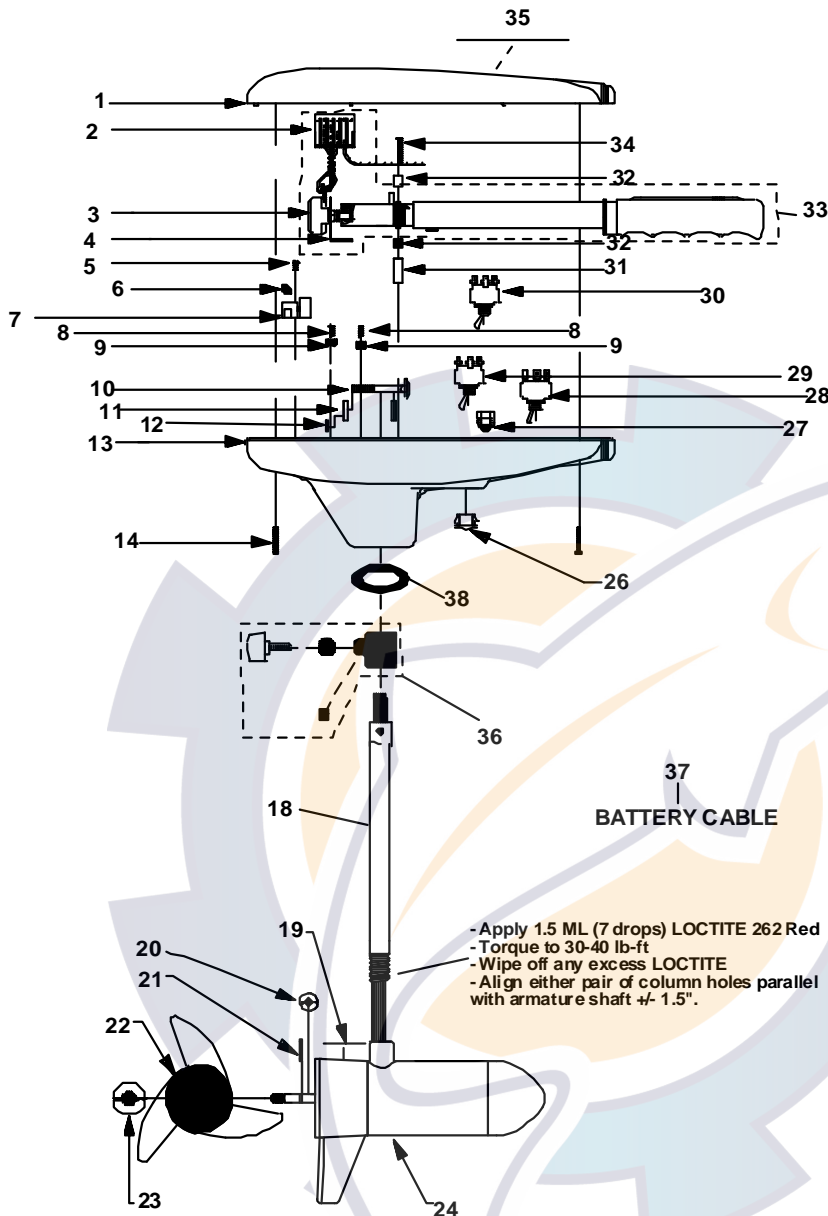

SPECIFICATIONS:

Year of Intro 1998
 Thrust 62 LBS
 Volts 24VDC
 Amp Draw 0 to 33 amps
 Mount 09 Transom
 Speeds Variable

QUICK REFERENCE PARTS GUIDE:

FOR/REV Switch FP153-06
 DA Board JF157-02
 MOSFET JF096-07
 Motor Seal Kit 6220

PARTS ORDERING & TECH ASSISTANCE

MotorGuide Consumer Relations
 Phone 918-831-6989
 Fax 800-982-8093

Send Returned Goods to:

MotorGuide
 605 Hwy 12 West
 Starkville, MS 39760

Returned Goods must be accompanied with a Returned Goods Authorization. Contact MotorGuide Consumer Relations to obtain RGA.

- Apply 1.5 ML (7 drops) LOCTITE 262 Red
 - Torque to 30-40 lb-ft
 - Wipe off any excess LOCTITE
 - Align either pair of column holes parallel with armature shaft +/- 1.5".

KEY	DESCRIPTION	PART #	KEY	DESCRIPTION	PART #
1	TOP HOUSING COVER BLACK	JT053-10	26	HOLE PLUG	FP021-03
2	AMP CONNECTOR	AP029-01	27	GROMMET	GR019-03
3	POTENTIOMETER	AP168-02	28	TOGGLE SWITCH 3 POSITIONS	FP153-05
4	POT BRACKET	AT155-03	29	FWD/REV SWITCH 2 POSITIONS	FP153-06
5	SELF TAPPING SCREW	AF141-01	30		
6	INSULATING SLEEVE	AT080-01	31	WIRE BRACKET	AT155-04
7	24 VOLT DURA AMP BOARD	JF157-02	32	RETAINER CLAMP	AR036-01
8	#10 X 1/2" SCREW	GR133-01	33	HANDLE ASY	AT372-03
9	TERMINAL BLOCK	FT160-01	34	8 X 1-3/8 SCREW	AR133-01
10	BOLT	TT134-01	35	NOMENCLATURE	JT056-09
11	CURVED WASHER	TT171-04	36	DEPTH COLLAR ASY	AR158-01
12	NYLON LOCK NUT	XT098-02	37	BATTERY CABLE	BT328-03
13	T/H BASE BLACK	AR004-14	38	COLUMN SEAL	AT079-01
14	SCREW #8 X 1"	LF141-04			
15	BAR KNOB DEPTH ADJUSTMENT	AR082-02			
16	COLUMN CLAMP WASHER	AR171-01			
17	COLUMN SUPPORT NUT	FR098-01			
18	COLUMN 42"	FR049-15			
	COLUMN 50"	FR049-13			
19	LOWER UNIT DECAL	ET060-04			
20	MONOFILAMENT WASHER	AR175-01			
21	PROP DRIVE PIN	BR102-01			
22	PROP/2 BLADE	AF124-07			
23	PROP NUT	AR099-01			
24	H/O MOTOR	UF397-01			
25	DEPTH ADJUSTMENT COLLAR	AR051-01			

